

Maintenance No. 42 ST

- A Release four allen screws (20) and remove top cap (1).
- B Remove split collars (28).
- C Lift all stripper arm (27).
- D Remove flanged bush (20).
- E Lift drum assembly (16) off centre stem assembly (17).
- F Remove bearings (23), spacer (24) and washer (3).
- G Remove key (10) from centre stem (7).
- H Withdraw spindle (10) from centre stem (7).
- I Release ratchet gear assemblies (20 & 21) (16 & 17) from centre stem (7) by removing retaining spindles (22 & 18).
- J Remove drive gear (11) from retaining plate (12).
- K Separate ratchet gear assembly (20 & 21).
- L Separate ratchet gear assembly (10 & 17).
- M Remove upper crown plate (2) by releasing three allen screws (22).
- N Lift off stripper ring assembly (6 & 5 & 25).
- O Clean thoroughly all parts

using kerosene (paraffin) or white petrol. Dry with a non-fluffy cloth.

P Replace stripper ring assembly (4 & 5 & 25) in drum (5).

Q Replace upper crown plate (3) with three allen screws (25).

R Check that pawls and springs (14 & 15) in pawl gear (12) are free and oil lightly.

S Lightly grease inner surface of ratchet gear (20) and fit pawl gear (21).

T Check that pawls and springs (14 & 15) in pawl gear (16) are free and oil lightly.

U Lightly grease inner surface of ratchet gear (17) and fit pawl gear (16).

V Lightly grease and replace drive gear (11) on retaining plate (12).

W Lightly grease and replace spindle (10) in centre stem (7).

X Fit key (10) in centre stem (7) ensuring it is located in groove on spindle (10).

Y Replace ratchet gear assembly (16 & 17) in centre stem (7) retaining it with spindle (18).

Z Check bush (19) in centre stem (7) and replace ratchet gear assembly (20 & 21) retaining it with spindle (22).

A. 1. Replace washer (9), bearings (23) and spacer (24) on centre stem (7).

B. 1. Lightly grease bearings and ratchet gear assemblies.

C. 1. Lightly grease drum gear teeth. Replace drum assembly (5) on centre stem assembly (17).

D. 1. Replace flanged bush (20) in upper crown plate (3).

E. 1. Fit all stripper arm (27) checking it is correctly located for rope load and properly positioned on stripper ring (6).

F. 1. Refit split collars (28).

G. 1. Replace top cap (1). Fasten with four allen screws (24).

NOTE If retaining plate (12) has to be replaced, remove which from boat and release clips (13).

Parts list

Item Number	Part Number	Description	No. Off
1	1504301	Top Cap	1
2	80131	Socket Head Cap Screw M ⁸ x 20 UNC x 1" long	3
3	1504263	Upper Crown Plate	1
4	1504264	Stripper Ring	1
5	1504266	Stripper Arm	2
6A	1504265	Drum (Bronze)	1
8A	1504267	Drum (Alum)	1
7	1504268	Centre Stem	1
8	1503005	Key	1
9	1504269	Washer	1
10	1504262	Spindle	1
11	1504209	Retaining Plate	1
12	1501607	Retaining Plate	1
13	8285	Clips, Stainless	1
14	15087	Pawl	4
15	15087	Pawl Spring	4
16	1504268	Pawl Gear	1
17	1503005	Ratchet Gear	1

18	1504205	Gear Spindle	1
19	1504301	Retaining Bush	1
20	1504306	Ratchet Gear	1
21	1504307	Pawl Gear	1
22	1504304	Driv Spindle	1
23	1501607	Cap Assembly Bearing	2
24	1504303	Spacer	1
25	1504310	Cap	1
26	1504260	Flanged Bush	1
27	1504265	Stripper Arm	2
28	1504268	Split Collar	1
29	80131	Socket Head Cap Screw M ⁸ x 20 UNC x 3/8" long	4

Spare Parts Kit

Model No 42 ST

Part No 15742100

Contents

- 1 x Key Part No 1501005
 4 x Spring Pt No 120017
 4 x Pawl Pt No 120018
 1 x Washer Pt No 15042010
 1 x Cleclo Pt No 82005

No. 42ST

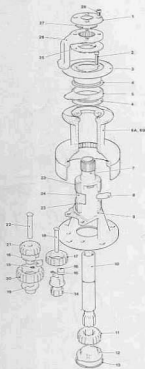

No. 42 Self Tailing Watch

Item No.	Part No.	Description	No. Off.
1	15042607	Top Cap	1
2	B-0721	Sk. Hd. Cap Screw - 1/4" UNC x 1" Long	3
3	15042604	Upper Crown Plate	1
4	15042641	Stripper Ring Insult	2
5	15042606	Stripper Ring	1
6A	15042432	Drum - Bronze	1
6B	15042602	Drum - Alloy	1
7	15042601	Carbide Steel	1
8	15010005	Key	1
9	15042010	Drum Washer	1
10	15042603	Spindle	1
11	15042009	Gear	1
12	15016007	Retaining Plate	1
13	B-7086	Circle	1
14	15042008	Pawl Gear	1
15	12607	Pawl Spring	4
16	12608	Pawl	4
17	15030005	Ratchet Gear	1
18	15042005	Gear Spindle	1
19	15042011	Retaining Bush	1
20	15042006	Ratchet Gear	1
21	15042007	Pawl Gear	1
22	15042004	Gear Spindle	1
23	15010007	Roller Bearing	2
24	15042012	Spacer	1
25	15042600	Flanged Bush	1
26	15042605	Stripper Arm	1
27	15042608	Cutter	2
28	B-0733	Sk. Hd. Cap Screw - 1/4" UNC x 1/4" Long	4